

West Apron Hangar Site – 2022-2024

Key Aspects

- Located on previous west apron
- Five (5) 12,000sf hangars with large hangar doors , 100'x 24' or 28'H
- Overhead doors , 14' x 16'
- Sewer, water utility and 120/208V 3ph power
- New access controls system / automatic vehicles gates on ramp
- Considerable new parking and aviation ramp

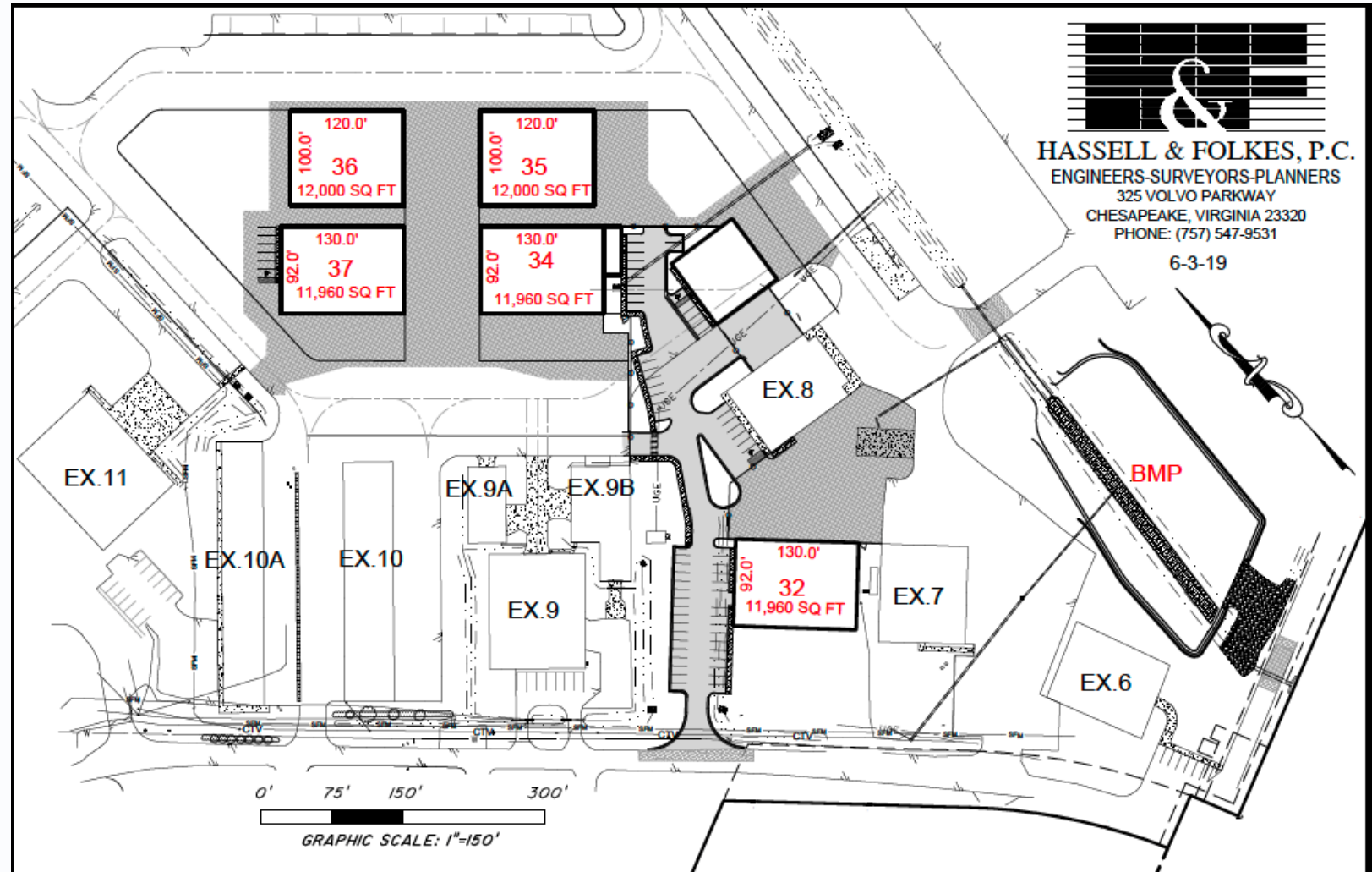

Recent Development – West Apron Hangar Site – 2022-2024

